

TECHNICAL SHEET – “A-DÔME” and “A-DÔME PLUS”

Skylight with high thermal performances compliant with EN 1873: 2014

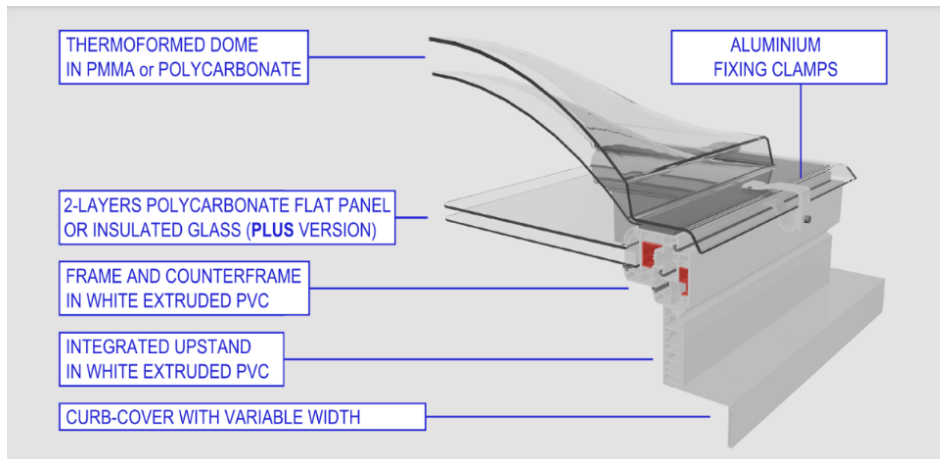

It is composed of a **4-layer** system in plastic material: 2 thermoformed layers outside and 2 flat ones inside, guaranteeing the high performance of the thermal insulation.

The structure of the system is realized with special profiles in **extruded white PVC** with metal inside and, in addition to frames and counter-frames that can be open, there is also an upstand and a flashing covering the curb in different dimensions to better fulfill the specific sizes and borders.

This flashing covering the curb is not necessary if there is a direct installation on the roof with no curb, since it becomes the same structure of the upstand in PVC replacing the wall of the frame; in this case, the waterproof covering will be put right on the same frame of the skylight by fixing it with a special aluminum profile that will be provided with the item.

The dome is fixed to the frame with **aluminum clamps**, equipped with hinges and stainless steel screws. The hinges, allowing the mobile frame to move, are placed in the inside, totally disappearing when the dome is closed; moreover, the material of the system is placed from the inside to avoid water leaks. All the materials that are used make the system theft-proof. The electrical triggers are not integrated inside the profiles to allow an easy maintenance.





Foto 4: Campione sottoposto a prova durante il test di tenuta all'acqua

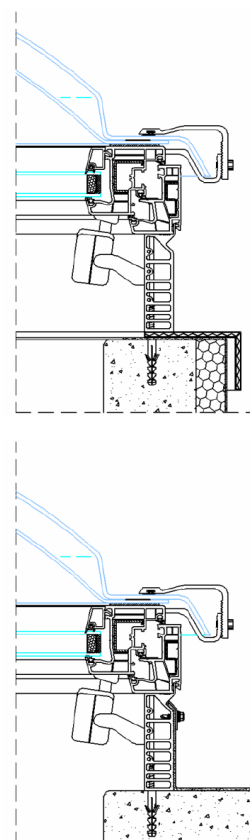

Foto 5: Campione sottoposto a prova durante il test di resistenza al carico verso l'alto (ignoring load)

Il presente Rapporto di prova è conforme alla norma UNI CEI EN ISO/IEC 17025

Upon request, we can also provide a manual opening system and, for some dimensions, an opening system to work as roof access hatch. It is also possible to realize products to be installed on sloped roofs with tiles.

This product is CE marked as it has been tested by the ITC-CNR (Institute for technology and construction) and it has been created to avoid condensation problems and energy wasting, in compliance with regulation EN 1873: 2014 - Individual roof lights of plastics (Product specification and test methods).

Tests have demonstrated the following values:



$U_w = 1,6 \text{ W/m}^2\text{K}$ pour A-DOME and

$U_w = 1,3 \text{ W/m}^2\text{K}$ pour A-DOME PLUS (version with isolated glass).

DOCUMENTS PROVIDED WITH THE PRODUCT

- The Declaration of Performance
- Certification of thermal transmittance
- Extract of the ITC-CNR test report on the coefficient of thermal transmittance

RANGE OF PRODUCTS

The range of sizes is the same of that of standard domes (from 40x40 cm to 200x200 cm – roof opening size – for square ones and 170x270 cm for rectangular ones, with variations of size of 10 cm for any side). The same is also for accessories of any kind: opening devices, mosquito nets, mobile sliding blinds, weather stations, but also remote controls for openings and batteries to open the device in case of no electricity supply available.